

**LEGEND**

- W PROPOSED WATER MAIN
- RW NON-DRINKING WATER MAIN
- S PROPOSED SEWER
- G PROPOSED GAS MAINS
- E PROP. ELECTRICAL CABLES
- C PROP. COMMS CABLES
- GWR PROPOSED GAS/WATER/RECYCLED CONDUIT
- PROPOSED DRAIN & PIT
- 4 DRAINAGE PIT No.
- HOUSE DRAIN PROPERTY INLET
- PROPOSED HOUSE DRAIN
- PROPOSED TOE OF BATTER
- OR PROPOSED TOP OF BATTER
- 31 PROPOSED DESIGN CONTOURS
- ExW Ex. WATER MAIN
- ExNDW Ex. NON-DRINKING WATER MAIN
- ExS Ex. SEWER
- FuS FUTURE SEWER
- ExG Ex. GAS MAINS & VALVE
- ExE Ex. ELECTRICAL CABLE
- ExC Ex. COMMS CABLES
- ExD Ex. DRAIN & PIT
- Ex Drain & Pit
- PSM TBM
- EXISTING LEVELS - (NO PREFIX)
- FS FINISHED SURFACE AFTER CUTTING OR FILLING
- Fb TOP OF PROPOSED BATTER
- Fp PROPOSED PAD LEVELS
- TP TANGENT POINT
- CH CHAINAGE
- WARNING TACTILES
- DIRECTIONAL
- DES PAD FLOOR
- FILL IN EXCESS OF 200mm

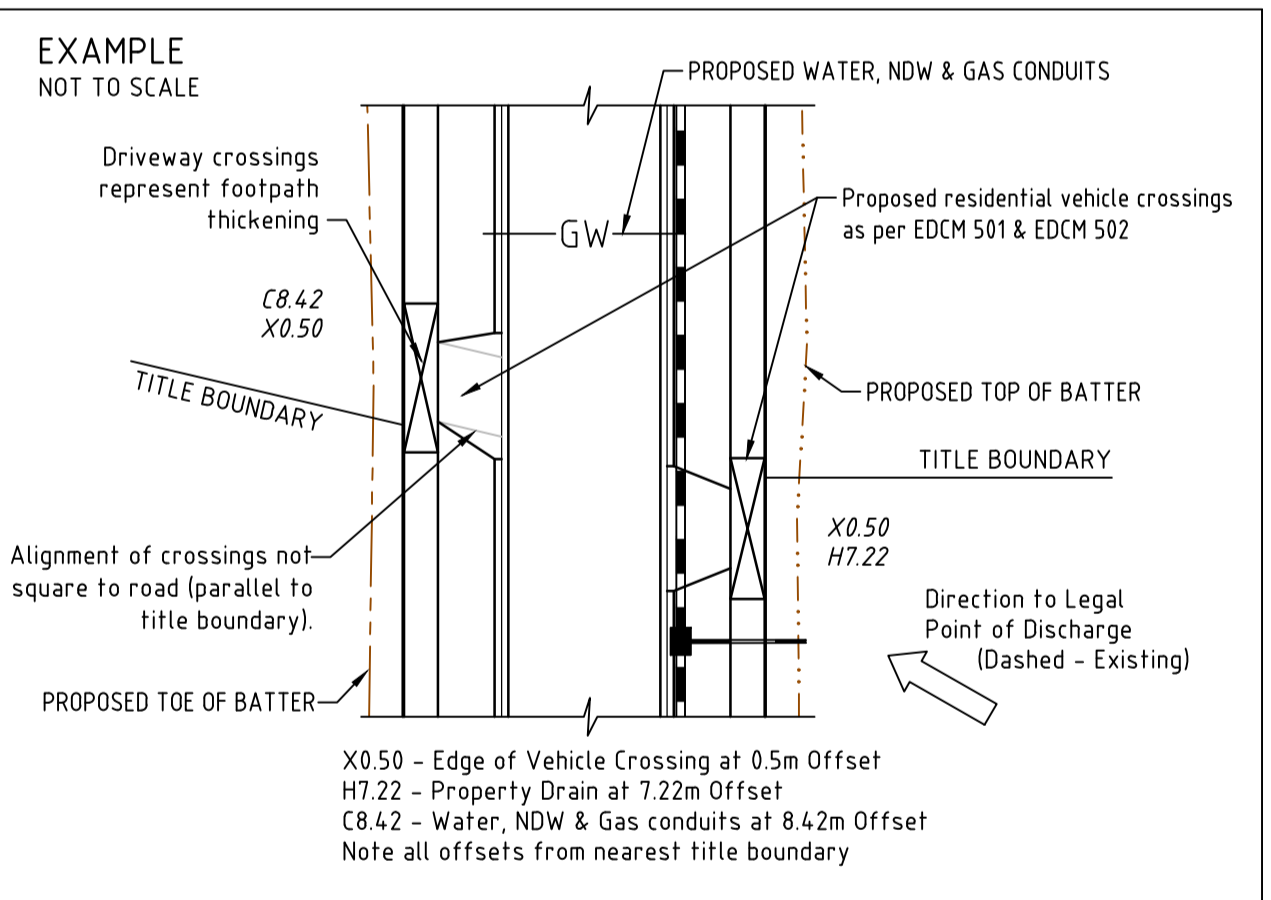
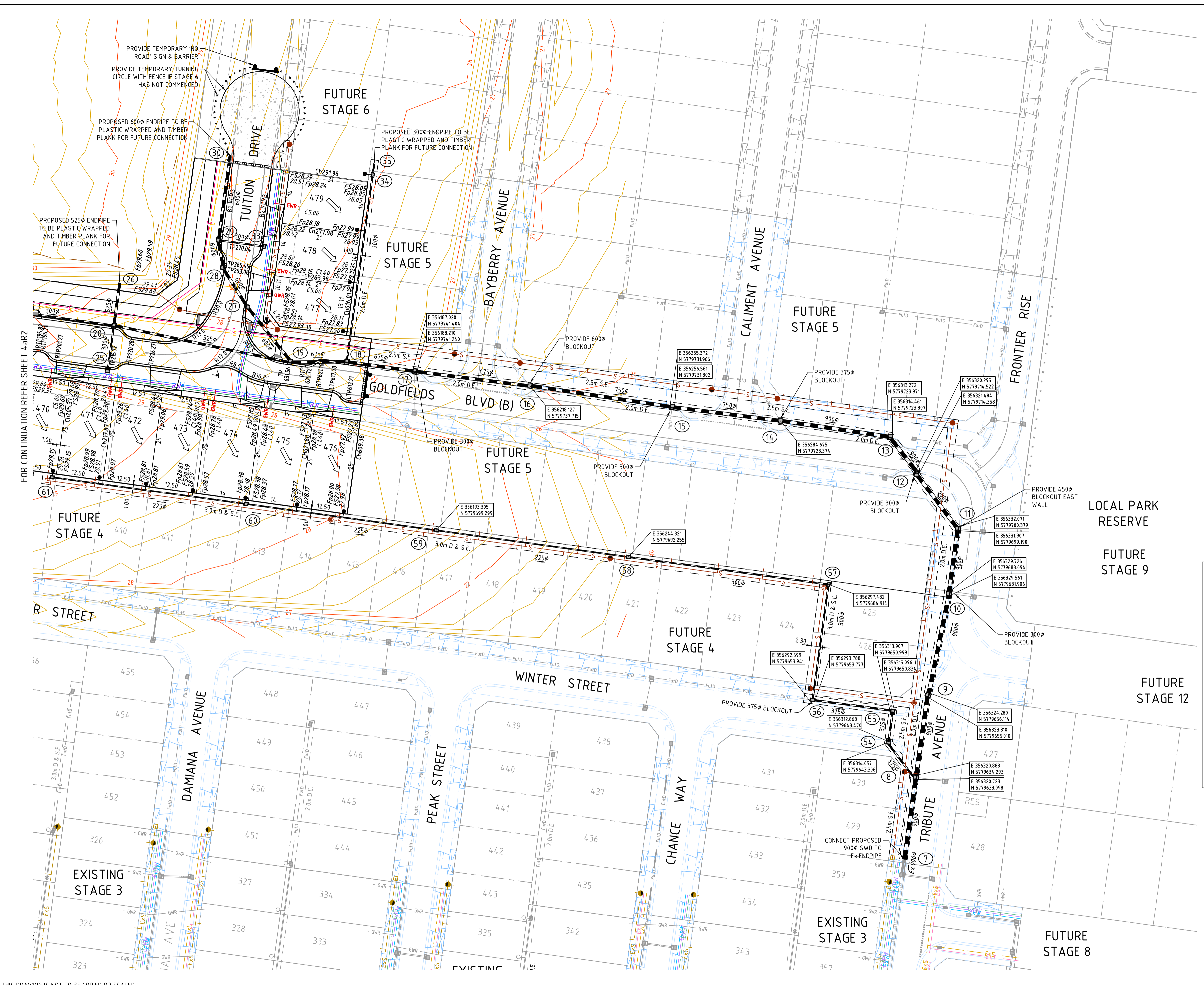

**WARNING**  
BEWARE OF UNDERGROUND SERVICES

The locations of underground services are approximate only and their exact position should be proven on site prior to commencing works. No guarantee is given that all existing services are shown.

**CONSTRUCTION PLAN**

H:\23555\STAGE 4A\LAYOUT.DWG SET, ROAD AND DRAINAGE\23555\_4AR2-3 & 14-16 LAYOUT PLANS AND INTERSECTION DETAIL(S).DWG

THIS DRAWING IS NOT TO BE COPIED OR SCALED

VERSION	REMARKS	DATE	APP'D
D	PROPOSED PAD LEVELS ADDED	23.07.24	JS
C	DRAFTING CHANGES	02.04.24	DJ
B	CONSTRUCTION ISSUE	15.11.23	JZ
A	PRELIMINARY ISSUE	25.08.23	LP

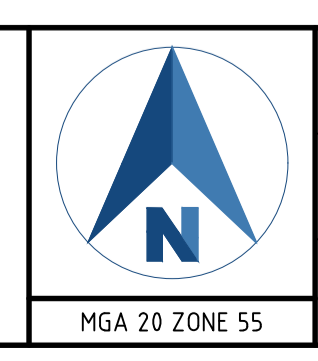
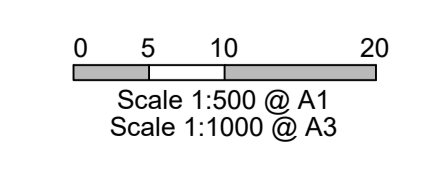

DRAWN BY	N. KASHA	DESIGNED BY	L. PHAN
MELWAY	135, F8	CHECKED BY	L. PHAN
DATUM	AHD	AUTHORISED BY	C. DAVIDSON

**REEDS CONSULTING**

LAND SURVEYING  
CIVIL ENGINEERING  
PLANNING  
DEVELOPMENT CONSULTING

www.reedsconsulting.com.au  
engineering@reedsconsulting.com.au

Lvl 14, 501 Swanston Street Melbourne Victoria 3000  
p 03 9440 3000  
Copyright © All Rights Reserved 2001

CITY OF CASEY VERVE ESTATE, CLYDE NORTH STAGE 4A LAYOUT PLAN - 2		DRAWING No. <b>4aR3</b>	VERSION <b>D</b>
		REFERENCE <b>23555E/4A</b>	